

## LFP 6.14-24.5 kWh

### Stacked Series

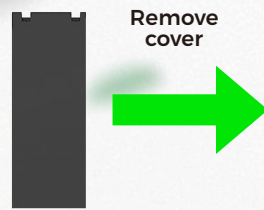

## FEATURES



Reliable LFP Cells



Safety Protection and Easy Move



Intelligent Build in BMS



High Inverter Compatibility



Easy Installation & After Sales Service



Digital monitoring system APP



>6,000 Cycles at 90% DOD



Scalable up to 24.5kW

# Uhome

## Nine advantages

- 1 Remote Monitoring
- 2 SOC Dynamic Calibration
- 3 Battery Integration Strategy
- 4 Parallel Connection
- 5 Triple Electrical Safety Protection
- 6 Voltage Balancing Between the Batteries
- 7 Accurate Acquisition of Battery's Information
- 8 ON/OFF Management Including Automatic Wake-up Function
- 9 Module design, Scalable up to 4 Battery Packs(6.14 kWh, 512V module)

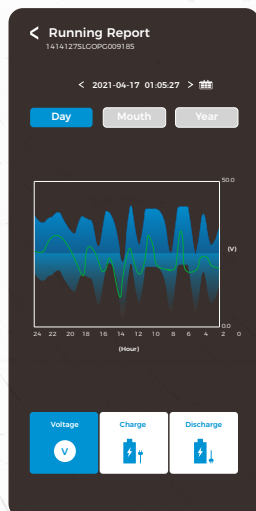
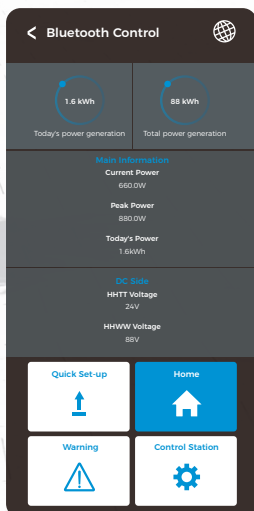

# Technical Specifications



Model	Uhome- INVT-3P-4kW	Uhome- INVT-3P-5kW	Uhome- INVT-3P-6kW	Uhome- INVT-3P-8kW	Uhome- INVT-3P-10kW	Uhome- INVT-3P-12kW
<b>Input (DC)</b>						
Max DC power	6000W	7500W	9000W	12000W	15000W	15000W
Max DC voltage	1000 Vd.c.					
MPPT voltage range	200...850 Vd.c.					
Max input current/per string	13Ax2					
Number of MPP trackers	2					
Number of input string	2					
<b>Battery Input</b>						
Battery Type	Li-Lon					
Battery voltage range	130-700V					
Maximum charge/dis charge current	25/25A					
Charge strategy for Li-thium Battery	Self-adaption to BMS					
<b>Output(AC)</b>						
AC nominal power	4000VA	5000VA	6000VA	8000VA	10000VA	12000VA
Max AC apparent power( AC Output)	5000VA	5500VA	7000VA	8800VA	11000VA	13200VA
Max output current	8A	10A	12A	15A	17A	20A
Nominal AC output	50/60HZ; 400/350					
AC output range	45/55HZ; 280-490 Vac(Adj)					
Power factor	0.8 leading...0.8laging					
Harmonics	< 3%					
Grid type	3W/N/PE					
Three-phase unbalance output	0-100%					0-80%
<b>AC Output(Back-up)</b>						
Max AC apparent power(Back-up AC)	4000VA	5000VA	6000VA	8000VA	10000VA	10000VA
Nominal Output Voltage	400/380V					
Nominal Output Frequency	50/60HZ					
Output THDV (@Liuear Load)	< 3%					
<b>Efficiency</b>						
Maximum conversion efficiency	98.0%	98.0%	98.2%	98.2%	98.2%	98.2%
European efficiency	97.3%	97.3%	97.5%	97.5%	97.5%	97.5%
Max battery to AC Efficiency	97.2%	97.2%	97.4%	97.4%	97.4%	97.4%
MPPT efficiency	99.9%	99.9%	99.9%	99.9%	99.9%	99.9%
<b>Safety and Protection</b>						
DC reverse-polarity protection	yes					
DC breaker	yes					
DC/AC SPD	yes					
Leakage current protection	yes					
Insulation Impedance Detection	yes					
Residual Current protection	yes					
Output short circuit protection	yes					
Battery reverse connection protection	yes					
<b>General Parameters</b>						
Dimension (W/H/D)	548*444*184mm					
Weight	27kg					
Operating temperature range °C	-25°C...+60°C					
Degree of protection	IP65					
Cooling concept	Natural convection					
Topology	Transformerless					
Display	LCD					
Humidity	0-95%no condensation					
Communication	Standard WiFi;GPRS/LAN(optional)					
Warranty	Standard 5 years; 7/10 years optional					
BMS communication	CAN/RS485					
Meter communication	RS485					
<b>Certificates and Approvals</b>						

CQC, VDE-AR-N4105, IEC61727, IEC62116, VDE0124-AR-N0124, EN50549, IEC62109, IEC62477

The range of output voltage and frequency may vary depending upon different grid codes.  
Specifications are subject to change without advance notice.

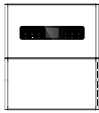
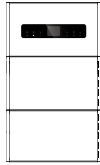

# Technical Specifications

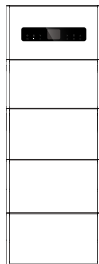
Energy Pod				
Items	6.14kWh	12.28kWh	18.42kWh	24.56kWh
Nominal Capacity	6.14kWh	12.28kWh	18.42kWh	24.56kWh
Size (L × W ×H)(mm)	650x210x410	650x210x820	650x210x1230	650x210x1640
Weight	60kg	120kg	180kg	240kg
Maximum Usable Capacity	5.53kWh	11.05kWh	16.58kWh	22.10kWh
Rated Discharge/ Charge Current	7.2A	14.4A	21.6A	28.8A
Nominal Dis-/Charge Power	3.69kW	7.37kW	11.06kW	14.75kW
Peak Power(Only Discharge)	6.14kW for 3s	12.28kW for 3s	18.42kW for 3s	24.56kW for 3s
Voltage	480-552Vd.c			
Nominal Battery Operating Voltage	512V			
Max. Battery Voltage	552V			
Max.recommended DOD	90%			
Operating Condition	Indoor or outdoor			
Operating Temperature	From -10-50 C			
WIFI Frequency Range	2400MHz-2483MHz			
Humidity	<60%(No condensed water)			
Pollution Degree	3			
Over Voltage Category	II			
Cooling Type	Natural cooling			
Case Material	Aluminium alloy			
IP rating	IP 65			
Efficiency	96%			
Protective Class	I			
Max. Number of Parallel	4			
Warranty	10 years			
Life Span	>15 years			
Communication	CAN/ RS485			
Battery Protection	Over-current/Over-voltage/Short circuit/ Under-voltage/Over temperature			
Hazardous Material Classification	9			
Transportation	UN 38.3			
Certification & Safety Standard	CE / UL1973 / IEC62619 / IEC 62477 / IEC 62040 / MSDS / UN38.3			